

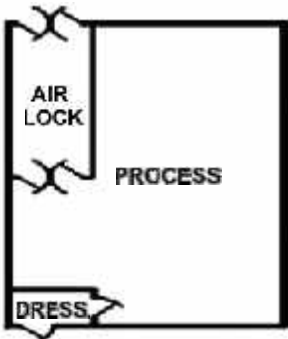

PHARMACEUTICAL LABEL MANUFACTURING

M&C SPECIALTIES CO.

SOUTHAMPTON, PA 18966



CLEAN ROOM
 10,000 Class - Certified
 26' x 50' x 14' High
 Manufacturing Facility



Supplied and Designed By:
 Johnson Building Systems, Inc.
 975 Jaymor Rd - Southampton, PA 18966-3854

Tel: 800-445-7249 or (215) 673-6050 Fax: (215) 322-2076 E-Mail: Sales@JohnsonEnergyGroup.com



CR-400 INSULATED PANEL SYSTEM

White Textured Fiberglass (FRP) .090" Both Sides or White (SMP) Painted, 019" Galvalume, Laminated to 4" EPS (1# Density), USDA Accepted Surface.

.090" FRP finished panels will absorb impact, and are also provided with exposed USDA White Painted Galvalume for applications where cleanability and moisture permeability are a factor.

5" & 6" INSULATED PANELS AVAILABLE CALL FOR PRICING

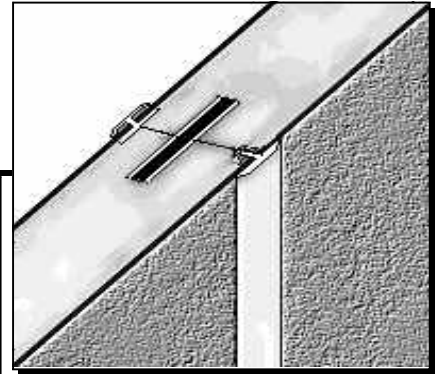

4" CR-400 Insulated Wall Panels

CONSTRUCTION DETAILS: WALKABLE SUSPENDED CEILING

CEILING "T" SYSTEM

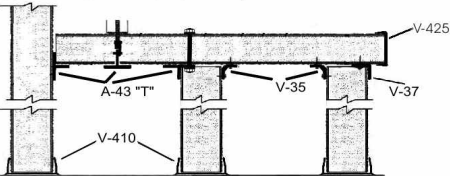

8', 10' & 12' Clear Span
resulting in less infiltration and continuous vapor barrier.



Optional: V-43 x 8' "T" Bar
PVC Flat Cover
V-42 Inside Corner
PVC Plastisol
8 mill finish
USDA accepted on exposed surface of panel

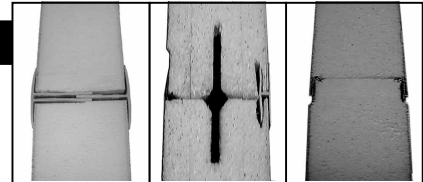

F9BE4

F9E4G

GBE4

TOP-VIEW

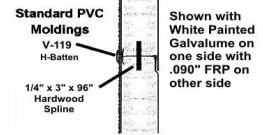

Electrical Chase Available

.090" FRP CLASS "A" FIRE RATED AVAILABLE



Standard EPS 1# Density Foam

Prod.No.	46" (Nom) Wide Panels are manufactured to size from 8' to 24' high with 4" EPS insulated solid core		Available	
			Square Edge	Detailed Edge
CR400-F9BE4	.090" FRP Textured White / 4" EPS Insulation / .090" FRP Textured White			
CR400-F9E4G	.090" FRP / 4" EPS Insulation / .019" Galvalume White Stucco Embossed			
CR400-GBE4	.019" Galvalume White Stucco Embossed Both Sides / 4" EPS Insulation			
Prod.No.	White PVC and Aluminum Moldings (8' or 10')			
V-35		PVC 2" X 2" INSIDE CORNER ANGLE		
V-37		PVC 2" X 2" OUTSIDE CORNER ANGLE		
V-417		2" X 5" HD OUTSIDE CORNER ANGLE		
V-45		PVC 2" "T" BAR (DUAL DUROMETER w/.625" LEG)		
V-119		PVC "H" BATTEN (1.125" FACE 13/16" LEG)		
V-432		4" TWO PIECE DIVISION BAR (ADJUSTABLE 2-3/4" TO 4")		
V-445		PVC 4" LEDGE CAP (2" LEGS) (W/G/B)		
V-425		PVC 4" HD END CAP (2" LEGS)		
V-410		PVC 4" FLOOR SCREED (2-1/2" LEGS) (W/G/B)		
A-40		WHITE ALUMINUM 2" X 2" CORNER ANGLE 90°		
A-46		WHITE ALUMINUM 3" X 3" CORNER ANGLE 90°		
A-45		WHITE ALUMINUM 3" X 3" CORNER ANGLE 120°		
A-43		WHITE ALUMINUM 4" X 2" CEILING T-Bar		
A-44		WHITE ALUMINUM 4" X 1-1/2" BASE CHANNEL		
PVC CORROSION RESISTANT COVERS		3/8" ZINC PLATED CEILING HARDWARE		
For use with A-40 and A-43 Aluminum Moldings		2200	C-Clamps-Zinc Plated	
V-43		4"x8' T-BAR FLAT (A-43)	4400-HD Eye-Coupling w/nut&bolt	
V-42		2"x2"x8' INSIDE CORNER (A-43)	1880 6' Redi Rod	
V-41		2"x2"x8' OUTSIDE CORNER (A-40)	4420 Redi Rod Connector	