



POWER PACKAGING

BEVERAGE PLANT - READING, PA 19605



System Supplied and Designed By:

Johnson Building Systems, Inc.

975 Jaymor Rd - Southampton, PA 18966

Tel: 800-445-7249 or (215) 673-6050 Fax: (215) 322-2076 E-Mail: Sales@JohnsonEnergyGroup.com



4" FRP INSULATED PANEL SYSTEM

White Textured Fiberglass (FRP) .090" Laminated to EPS, XPS (Polystyrene) or ISO (Isocyanurate/Polyurethane). USDA Accepted Surface. Colors Available.

.090" FRP finished panels will absorb impact and are provided with a reinforced backside of 28 Ga. Smooth Galvanized with Epoxy Clear Coat Finish or USDA White Painted for applications where cleanability vapor barrier and moisture permeability are a factor, and .090 FRP is exposed to wash down.

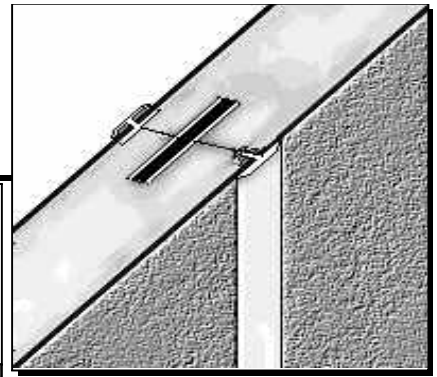

FRP Doors Available

Top-View

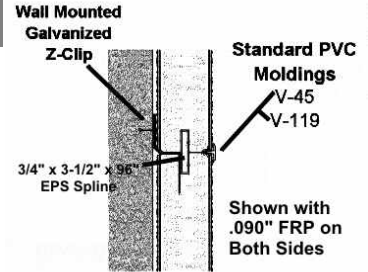

Shown with .090" FRP on Both Sides

CONSTRUCTION DETAILS: WALKABLE SUSPENDED CEILING SYSTEM

CEILING "T" SYSTEM

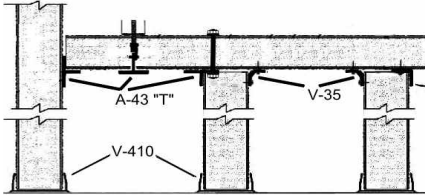

WOOD "SPLINE" SYSTEM

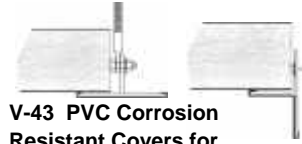
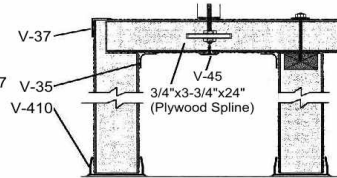

V-43 PVC Corrosion Resistant Covers for A-43 "T" Bar Suspended Ceiling System

V-42 PVC Inside Cover for A-43 "T" Bar Wall Mount

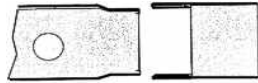

Electrical Chase Available

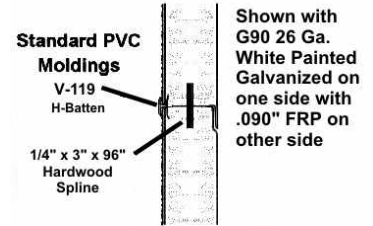

Shown with G90 26 Ga. White Painted Galvanized on one side with .090" FRP on other side

Prod.No.	46" (Nom.) wide Panels are manufactured to size from 8' to 24' high with 4" insulated core			Price (Sq.Ft.)			
	EPS	XPS					
F9BE4	.090" FRP / 4" Insulation / .090" FRP Pebble White			\$4.45	\$4.95		
F9E4G	.090" FRP / 4" Insulation / Smooth White Painted 26 Ga. Galvanized			\$4.25	\$4.70		
F9E4C	.090" FRP / 4" Insulation / Smooth 28 Ga. Galvanized with Epoxy Clear Coat			\$3.95	\$4.40		
Prod.No.	White PVC and Aluminum Moldings:			EA. 8'	EA. 10'	EA. 12'	
V-35		PVC 2" X 2" INSIDE CORNER ANGLE		\$6.50	\$8.25	\$9.95	
V-37		PVC 2" X 2" OUTSIDE CORNER ANGLE		\$6.50	\$8.25	\$9.95	
V-167		PVC 2" X 4" OUTSIDE CORNER ANGLE		\$18.30	\$22.85	\$27.50	
V-45		PVC 2" "T" BAR (DUAL DUROMETER w/.625" LEG)		\$3.90	\$4.85	\$5.85	
V-119		PVC "H" BATTEN (1.125" FACE 13/16" LEG)		\$2.90	\$3.85	\$4.65	
V-411		PVC 4" CAP (1-7/8" LEGS)		\$21.55	\$26.95	\$32.30	
V-410		PVC 4" FLOOR SCREED (2-1/2" LEGS) (WHITE / GRAY)		\$26.50	-	-	
A-40		WHITE ALUMINUM 2" X 2" CORNER ANGLE (MAX 20' - \$53.00)		\$21.20	\$26.50	\$31.80	
A-46		WHITE ALUMINUM 3" X 3" CORNER ANGLE (MAX 20' - \$75.00)		\$30.00	\$37.50	\$45.00	
A-43		WHITE ALUMINUM 4" X 2" CEILING T-Bar (MAX 20' - \$80.00)		\$34.00	\$40.00	\$48.00	
A-44		WHITE ALUMINUM 4" X 1-1/2" BASE CHANNEL (MAX 20' - \$84.00)		\$39.00	\$45.00	\$53.00	
PVC CORROSION RESISTANT COVERS			Net Price	SPLINE JOINTS	Net Each	Per Box	Net Price
V-43		4"x8' FLAT T-BAR (A-43)	\$6.40	EPS - 3/4" x 3-3/4" x 96"	\$0.65	100	\$65.00
V-42		2"x2"x8' INSIDE CORNER (A-43)	\$6.40	Hardboard 1/4"x2-3/8"x48"	\$2.15	60	\$129.00
V-41		2"x2"x8' OUTSIDE CORNER (A-40)	\$6.40	Plywood 3/4" x 3-3/4" x 24"	\$1.65	-	-